

## Plot 10 Poppy Gardens, Main Street

£285,000 Freehold

BRAND NEW THREE BEDROOM SEMI-DETACHED • EXCLUSIVE DEVELOPMENT of 17 PROPERTIES • FULLY INTEGRATED KITCHEN • EN-SUITE SHOWER ROOM to BEDROOM ONE • FAMILY BATHROOM & DOWNSTAIRS CLOAKROOM • CORNER PLOT with GOODSIZE REAR GARDEN • TWO ALLOCATED PARKING SPACES to the FRONT with EV CHARGING POINTS • AIR SOURCE HEAT PUMP (ASHP) • INTERNAL FLOOR AREA 869 sq ft • 3.9 MILES to the TRAIN STATION & CITY CENTRE



HUDSON  
HOMES



**Approximate total area<sup>(1)</sup>**  
869 ft<sup>2</sup>  
80.8 m<sup>2</sup>

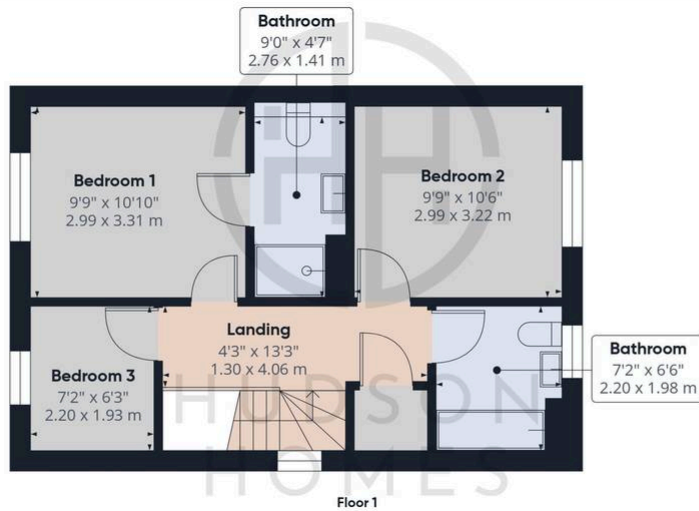

(1) Excluding balconies and terraces

Calculations reference the RICS IPMS 3C standard. Measurements are approximate and not to scale. This floor plan is intended for illustration only.

GIRAFFE360

Hudson Homes

8 Crusader Court, Yaxley, Peterborough, PE7 3PU