

151 Fletton Avenue, Peterborough

£240,000 Freehold

Two reception rooms, with stripped wood flooring in the dining room, adding character and warmth to the living space • Modern kitchen and shower room, offering contemporary and updated living spaces • Downstairs shower room, providing added convenience and flexibility for guests or family use • Original cast iron fireplaces in bedrooms one and three, adding period character and feature detail • Original stripped wooden doors, adding character and period charm throughout • South-facing rear garden with undercover seating area, ideal for year-round outdoor relaxation and entertaining • Off-road parking for two vehicles, with additional on-street parking available nearby, providing flexible parking options • Approximately 1.7 miles to the train station and city centre, with a coffee shop directly opposite and just a short walk to Pete's Bakery on Fletton High Street • Internal floor area approximately 893 sq ft, providing well-proportioned accommodation throughout • Council Tax Band B - approximately £1,700 per year

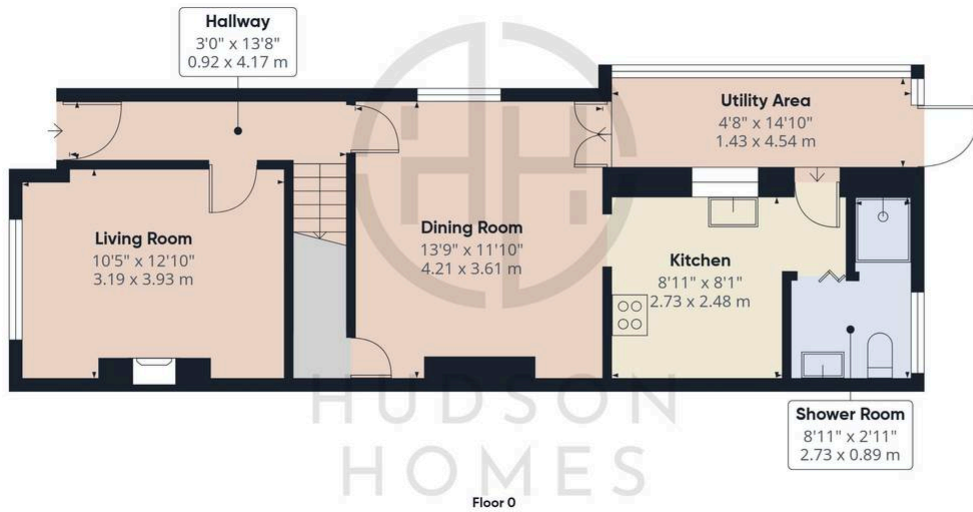

Approximate total area⁽¹⁾
881 ft²
81.9 m²



(1) Excluding balconies and terraces

Reduced headroom
..... Below 5 ft/1.5 m

Calculations reference the RICS IPMS 3C standard. Measurements are approximate and not to scale. This floor plan is intended for illustration only.

GIRAFFE360