



71 Martinsbridge, Peterborough

£180,000 Freehold

TWO BEDROOM MID TERRACE HOME • IDEAL FIRST TIME PURCHASE • CONSERVATORY LEADING TO GARDEN
 • ENCLOSED, LOW MAINTENANCE REAR GARDEN • ALLOCATED PARKING SPACE • INTERNAL FLOOR AREA 626
 SQFT • COUNCIL TAX BAND A • CLOSE TO CITY CENTRE • CLOSE TO AMENITIES



HUDSON
HOMES

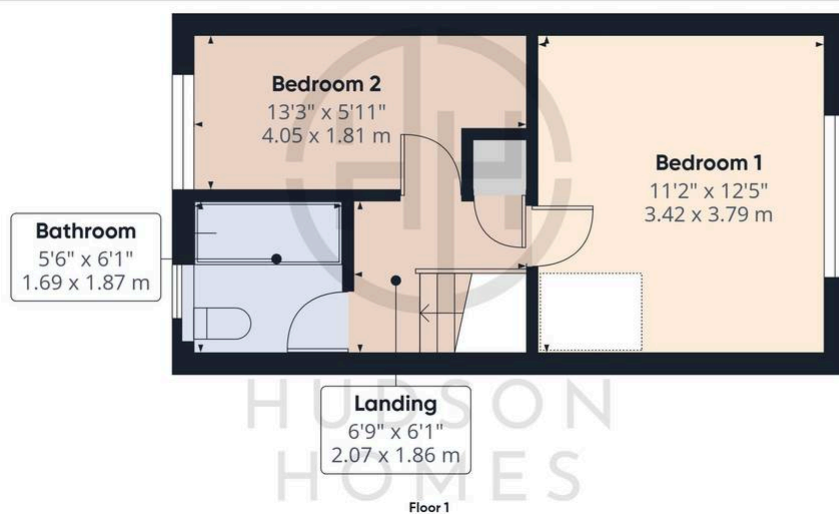
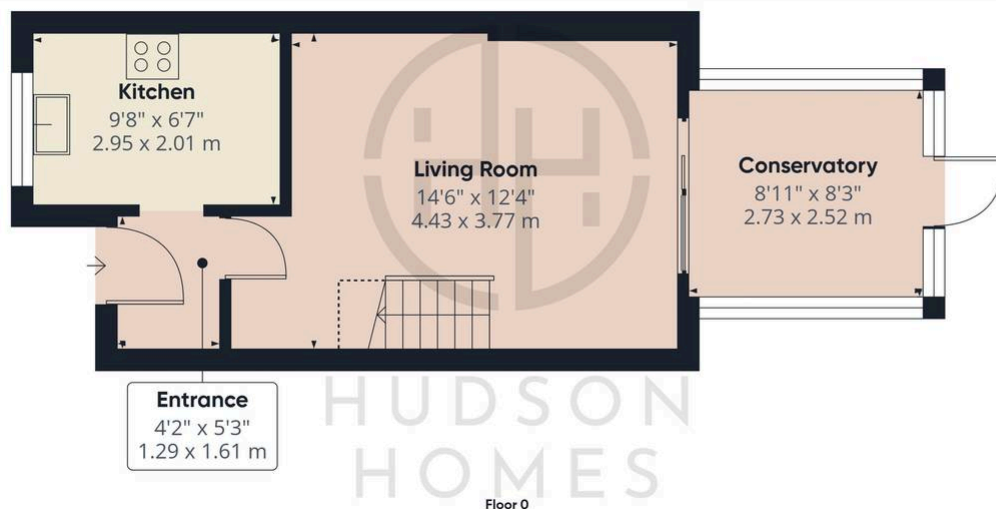

Approximate total area⁽¹⁾

626 ft²

58.2 m²

Reduced headroom

13 ft²

1.2 m²

(1) Excluding balconies and terraces

Reduced headroom

Below 5 ft/1.5 m

Calculations reference the RICS IPMS 3C standard. Measurements are approximate and not to scale. This floor plan is intended for illustration only.

GIRAFFE360

Hudson Homes
8 Crusader court, Yaxley

PE7 3PU

info@hudson-homes.co.uk

01733 788222