

## 17 Houghton Way, Stilton

£91,000 Leasehold

IDEAL 1st TIME BUY • NO FORWARD CHAIN • 35% SHARED OWNERSHIP • REMAINING 65% = £432.29 pcm  
 INCLUDING SERVICE CHARGE OF £55.02 • LOUNGE/DINING ROOM • DOWNSTAIRS WC & FAMILY BATHROOM •  
 TWO DOUBLE BEDROOMS • TWO ALLOCATED PARKING SPACES TO THE FRONT • EASY ACCESS TO A1(M) & A605  
 • SHORT WALK TO SHOPS, PUBS & RESTAURANTS



HUDSON  
HOMES

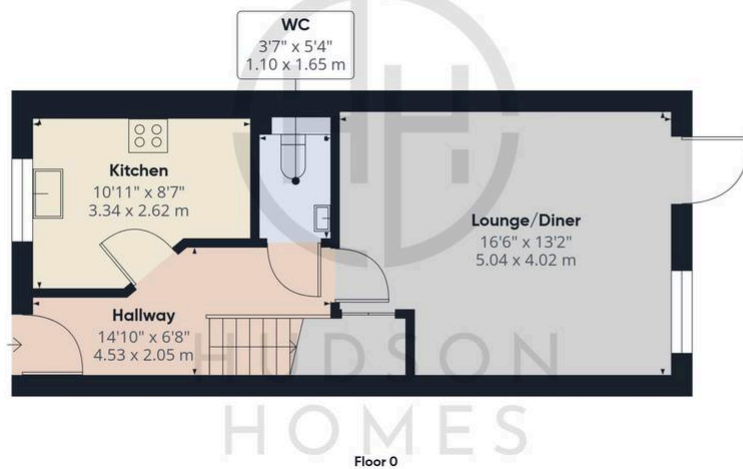

**Approximate total area<sup>(1)</sup>**  
796 ft<sup>2</sup>  
73.9 m<sup>2</sup>

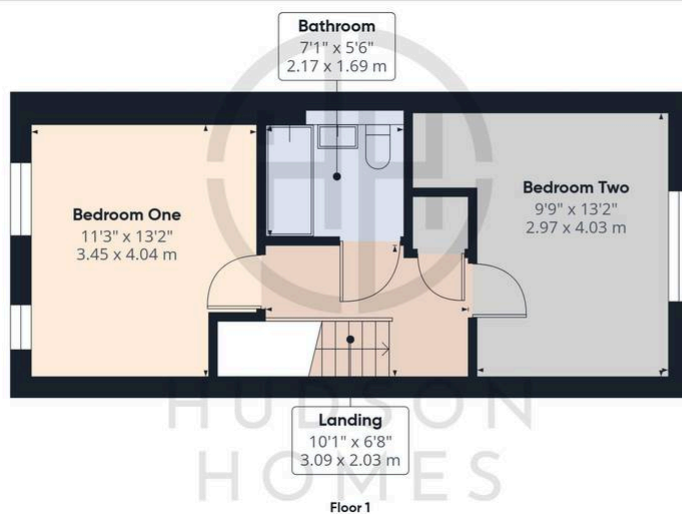

(1) Excluding balconies and terraces

Calculations reference the RICS IPMS 3C standard. Measurements are approximate and not to scale. This floor plan is intended for illustration only.

GIRAFFE360

Hudson Homes

8 Crusader Way, Yaxley, PE7 3PU

01733 788 222