



4 East Water Crescent, Hampton Vale

£290,000 Freehold

FANTASTIC LAKE VIEWS TO THE FRONT • THREE/FOUR BEDROOMS • INTERNAL FLOOR AREA 1044SQFT • COUNCIL TAX BAND D • DRIVEWAY WITH GATED ACCESS LEADING TO GARAGE • CLOSE TO LOCAL SCHOOLS & AMENITIES INC SERPENTINE GREEN • EN-SUITE TO MASTER BEDROOM • RE-FITTED BOILER WITHIN THE LAST YEAR • THREE STOREY TOWNHOUSE • CONSERVATORY WITH DOORS TO REAR GARDEN



HUDSON
HOMES

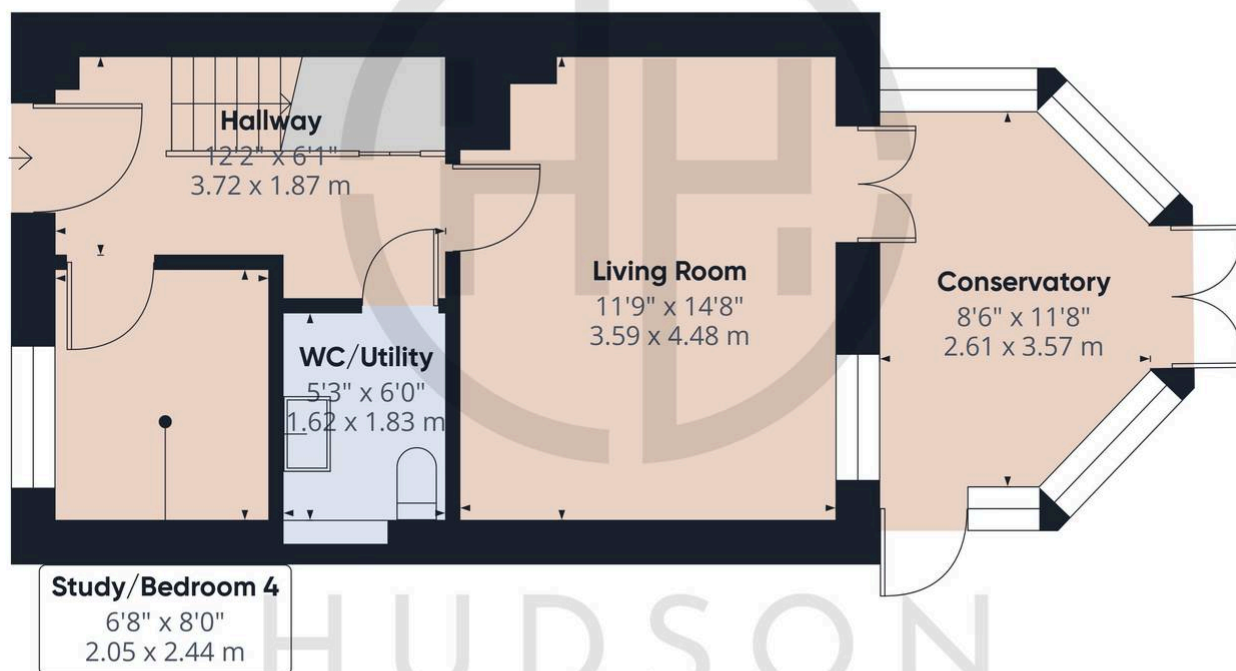

Approximate total area⁽¹⁾
429 ft²
39.9 m²

(1) Excluding balconies and terraces

While every attempt has been made to ensure accuracy, all measurements are approximate, not to scale. This floor plan is for illustrative purposes only.

Calculations are based on RICS IPMS 3C standard.

GIRAFFE360

Floor 0

01733 788222

info@hudson-homes.co.uk

8 Crusader court

PE7 3PU