



4 Chartwell Close, Peterborough

£225,000 Freehold

NO FORWARD CHAIN • SPLIT LEVEL LIVING SET OVER 3 FLOORS • OPEN PLAN KITCHEN/LIVING AREA • TWO UPPER BEDROOMS & ONE LOWER GROUND BEDROOM • SHOWER ROOM & BATHROOM • ELECTRIC HEATING THROUGHOUT • FULLY ENCLOSED PATIO GARDEN • INTERNAL FLOOR AREA 143.39 SQUARE METRES • ALLOCATED PARKING SPACE • 1.2 MILES TO PETERBOROUGH TRAIN STATION & CITY CENTRE



HUDSON
HOMES



HUDSON
HOMES

Floor 0

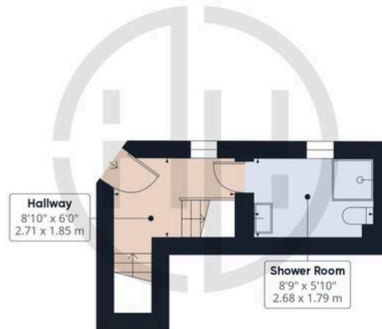

HUDSON
HOMES

Floor 0½



HUDSON
HOMES

Floor 1

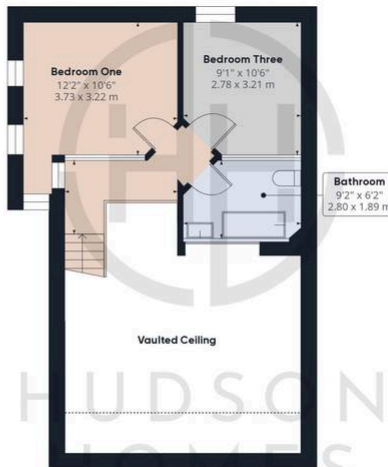

HUDSON
HOMES

Floor 2



Approximate total area⁽¹⁾

871.23 ft²
80.94 m²

Reduced headroom

1.26 ft²
0.12 m²

(1) Excluding balconies and terraces

Reduced headroom

..... Below 5 ft/1.5 m

While every attempt has been made to ensure accuracy, all measurements are approximate, not to scale. This floor plan is for illustrative purposes only.

Calculations were based on RICS IPMS 3C standard. Please note that calculations were adjusted by a third party and therefore may not comply with RICS IPMS 3C.

GIRAFFE360

01733 788222

info@hudson-homes.co.uk

8 Crusader court

PE7 3PU