

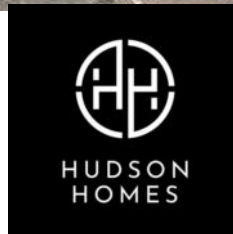

26 Keeper Hill Drive, Hampton Heights
Peterborough



£525,000



26 Keeper Hill Drive

Hampton Heights, Peterborough

Immaculately presented, this stunning 5 bedroom detached house exudes quality and elegance in every corner. Showered in natural light from the south facing garden, the home boasts a first-floor living room complemented by a ground floor sitting room, offering flexibility and space for modern family living. The heart of the home lies in the integrated kitchen/dining room featuring a stylish island and a utility room, perfect for hosting and entertaining. With two en-suites, a family bathroom, and a cloakroom, convenience and comfort are at the forefront of this abode, measuring an impressive 1948.27 sqft internally.

Situated a mere 5.7 miles from Peterborough Train Station and city centre, the property enjoys seamless access to the A1 (M) and A605, ensuring excellent connectivity with all major road networks. The enchanting neighbourhood beckons with a short stroll to picturesque lakes and verdant green spaces, providing a serene backdrop for leisurely walks. Moreover, the property is ideally located within walking distance to a range of amenities including shops and schools, promising a lifestyle of utmost convenience and comfort.

Externally, the property is enveloped in charm, featuring an open plan front garden with lush lawn and side borders. A block-paved driveway and gated side access lead to the fully enclosed rear garden offering a tranquil haven with its manicured lawn and inviting patio area.







Floor 0



Floor 1

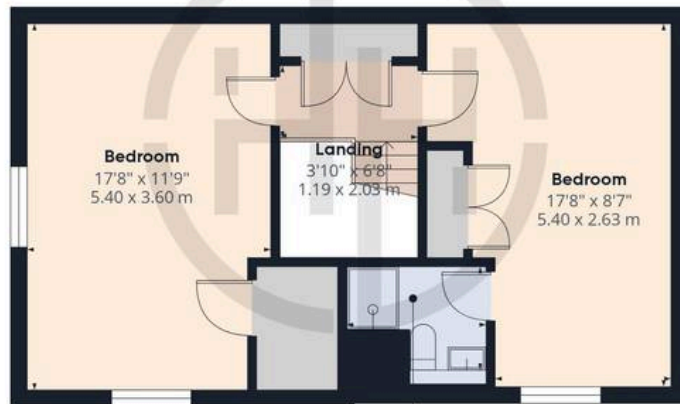

Floor 2

Approximate total area⁽¹⁾
1968.82 ft²
182.91 m²

(1) Excluding balconies and terraces

While every attempt has been made to ensure accuracy, all measurements are approximate, not to scale. This floor plan is for illustrative purposes only.

Calculations are based on RICS IPMS 3C standard.

GIRAFFE 360



Hudson Homes Estate Agents

8 Crusader Court, Yaxley - PE7 3PU

01733 788222

info@hudson-homes.co.uk

www.hudson-homes.co.uk/

