

14d Molyneux Square, Hampton Vale

£145,000 Leasehold

2nd FLOOR APARTMENT • SERVICE CHARGE IS £140.88 PER MONTH & GROUND RENT £100 PER YEAR • 115 YEARS REMAINING ON THE LEASE • OPEN PLAN LIVING • ONE DOUBLE & ONE SINGLE BEDROOM • GAS CENTRAL HEATING & uPVC DOUBLE GLAZING • ONE ALLOCATED PARKING SPACE • COUNCIL TAX BAND B £1610 • CLOSE TO SHOPS & ALL AMENITIES • EASY ACCESS TO A1(M) & A605



HUDSON
HOMES

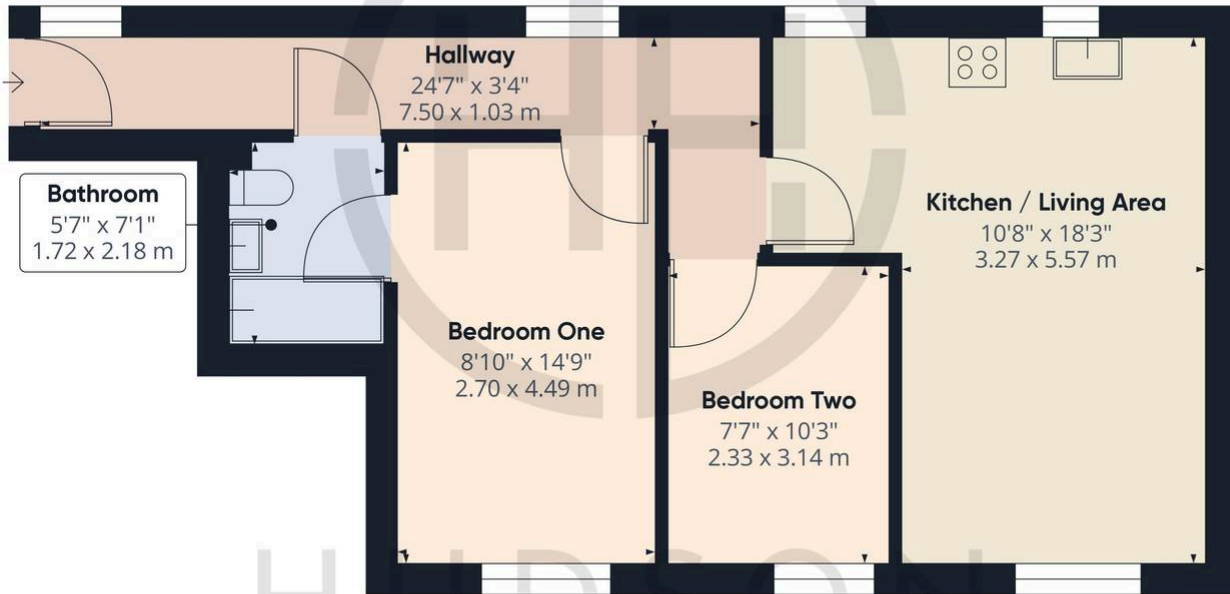

Approximate total area^①
577.7 ft²
53.67 m²

(1) Excluding balconies and terraces

While every attempt has been made to ensure accuracy, all measurements are approximate, not to scale. This floor plan is for illustrative purposes only.

Calculations are based on RICS IPMS 3C standard.

GIRAFFE360

01733 788222

info@hudson-homes.co.uk

8 Crusader Court

PE7 3PU