

15 Adlington Close, Hampton Gardens

£220,000 Freehold

5 YEARS LEFT ON THE NHBC WARRANTY • KITCHEN/DINER WITH FRENCH DOORS TO THE GARDEN • BATHROOM & CLOAKROOM • ENCLOSE REAR GARDEN WITH SHED THAT HAS POWER • TWO ALLOCATED PARKING SPACES TO THE SIDE OF THE HOUSE • INTERNAL FLOOR AREA 58 SQUARE METRES • WALKING DISTANCE TO SHOPS & SCHOOLS • EASY ACCESS TO A1(M) & A605 • 3.5 MILES TO THE TRAIN STATION & CITY CENTRE • PERFECT 1ST TIME BUYER INVESTMENT PURCHASE (£1000PCM)

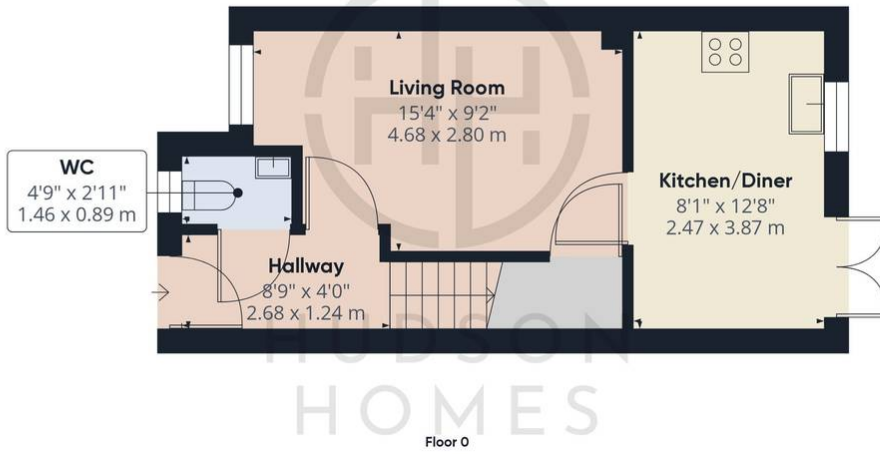



Approximate total area⁽¹⁾
579.31 ft²
53.82 m²

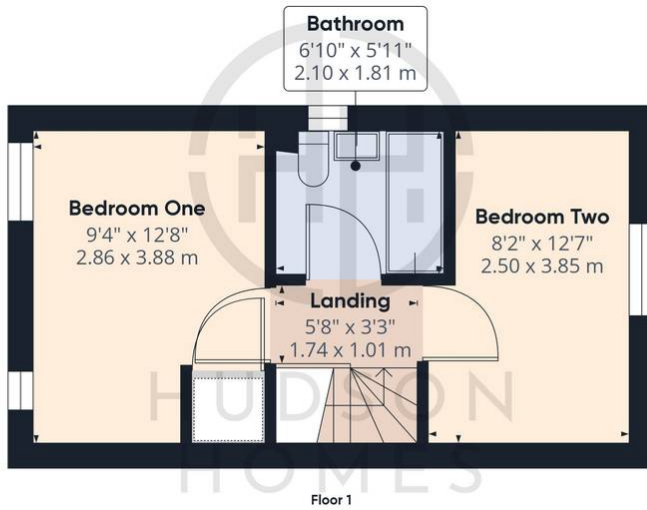

(1) Excluding balconies and terraces

While every attempt has been made to ensure accuracy, all measurements are approximate, not to scale. This floor plan is for illustrative purposes only. Calculations are based on RICS IPMS 3C standard.

GIRAFFE360

You can include any text here. The text can be modified upon generating your brochure.