

79 Main Street, Yaxley

£215,000 Freehold

FULLY REFURBISHED THROUGHOUT IN 2021 • OPEN PLAN LOUNGE/DINING ROOM • UPSTAIRS BATHROOM • OFF ROAD PARKING FOR 2/3 VEHICLES • INTERNAL FLOOR AREA 80 SQUARE METRES • GOOD SIZE REAR GARDEN • CLOSE TO SHOPS & SCHOOLS • IDEAL FIRST TIME BUY • SITUATED IN THE HEART OF THE VILLAGE • COUNCIL TAX BAND A £1548pa

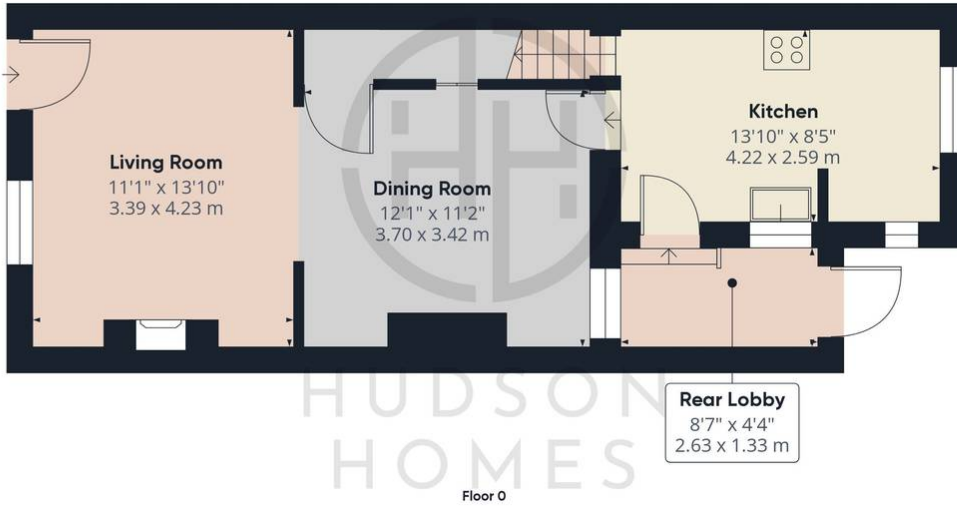



Approximate total area⁽¹⁾
838.06 ft²
77.86 m²

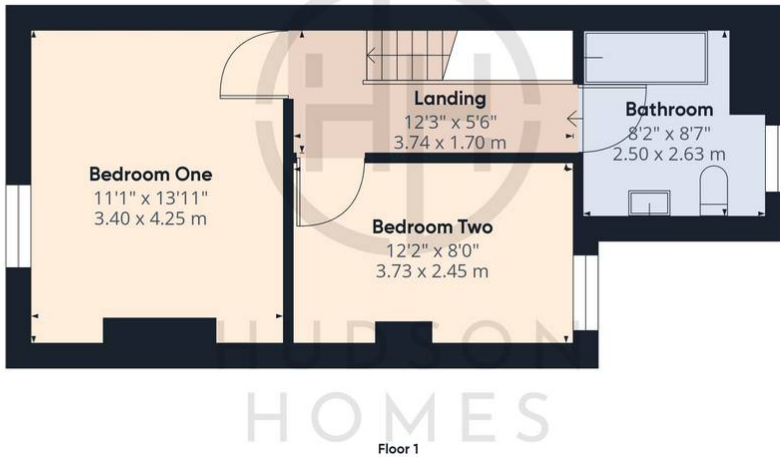

(1) Excluding balconies and terraces

While every attempt has been made to ensure accuracy, all measurements are approximate, not to scale. This floor plan is for illustrative purposes only.

GIRAFFE360

Hudson Homes

8 Crusader Court, Yaxley, Peterborough PE7 3PU

Phone: [01733 788222](tel:01733788222)

Email: info@hudson-homes.co.uk