

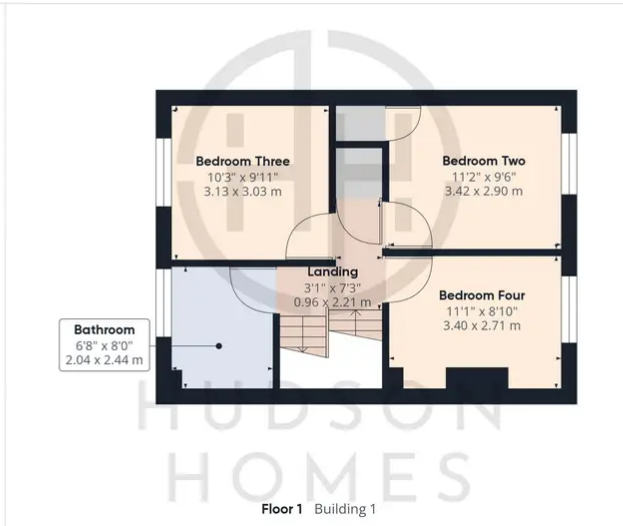

## 4 Needham Court, Yaxley

£350,000 Freehold

KITCHEN/DINING ROOM • TWO RECEPTION ROOMS • FOUR DOUBLE BEDROOMS • EN-SUITE SHOWER ROOM & DRESSING AREA TO BEDROOM ONE • FAMILY BATHROOM & CLOAKROOM • ENCLOSED REAR GARDEN WITH OUTSIDE BBQ / KITCHEN AREA • INTERNAL FLOOR AREA 139 SQUARE METRES • COUNCIL TAX BAND C £2064.00 • QUIET CUL-DE-SAC LOCATION • SINGLE GARAGE & 2 PARKING SPACES

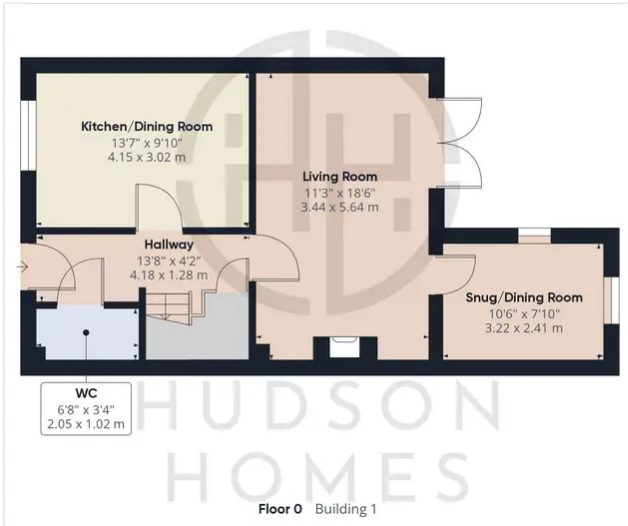

HUDSON  
HOMES

**Approximate total area<sup>(1)</sup>**

1377.13 ft<sup>2</sup>  
127.94 m<sup>2</sup>

**Reduced headroom**

31.5 ft<sup>2</sup>  
2.93 m<sup>2</sup>

(1) Excluding balconies and terraces

⌊ Reduced headroom  
(below 1.5m/4.92ft)

While every attempt has been made to ensure accuracy, all measurements are approximate, not to scale. This floor plan is for illustrative purposes only.

GIRAFFE360

You can include any text here. The text can be modified upon generating your brochure.