



331 March Road, Whittlesey
Peterborough



£575,000



331 March Road

Whittlesey, Peterborough

Come take a peek at this gem of a property nestled in a charming rural location. This spacious 4-bedroom detached house is situated on a generous 1.06-acre plot, offering plenty of room to stretch out and enjoy the great outdoors and potential to extend (STP)

Step inside, and you'll be greeted by a total floor area of 190 square metres, giving you ample space to create your dream living environment. The heart of the home is the open-plan kitchen/diner, perfect for whipping up delicious meals and entertaining guests. There's also a separate utility room for added convenience.

If you're in need of some downtime, you'll be spoilt for choice with not one, not two, but three reception rooms to relax and unwind in. The galleried landing adds a touch of elegance to the home, creating a sense of grandeur as you move about the property.

Head upstairs to discover four double bedrooms, providing comfortable accommodations for all. The master bedroom features an en-suite bathroom and access to a rooftop terrace, where you can enjoy stunning views and soak up the sunshine.

In addition to the en-suite, there's also a family bathroom and a cloakroom, ensuring that there's no need to queue up for the shower in the morning rush.







Ground Floor

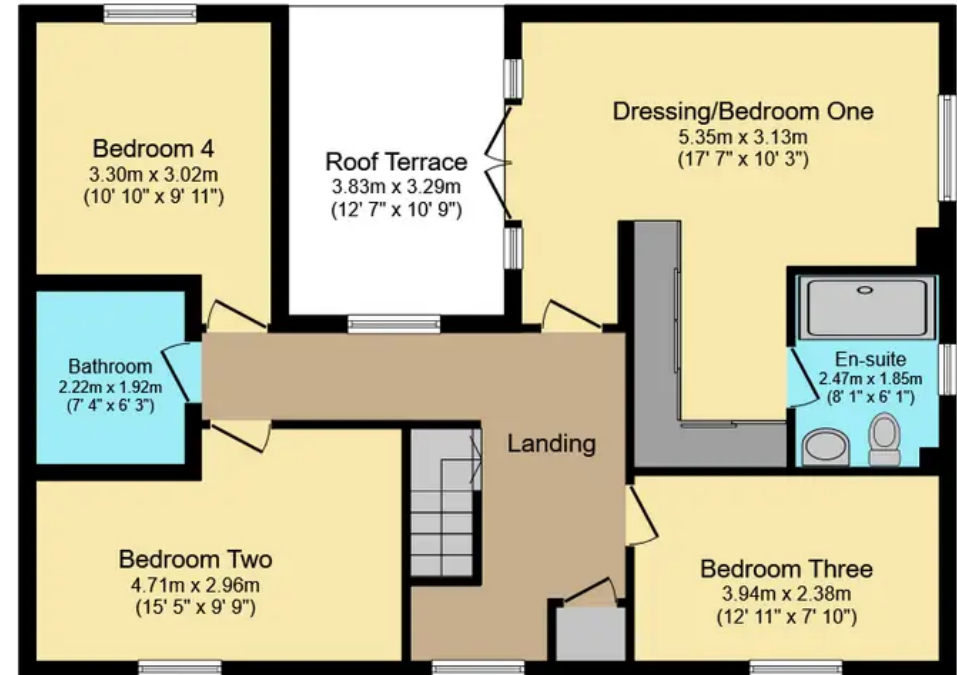

First Floor



Hudson Homes Estate Agents

122a Main Street, Yaxley - PE7 3LP

01733 788222

info@hudson-homes.co.uk

www.hudson-homes.co.uk/

