



26 Blenheim Way, Yaxley
Peterborough



£255,000



26 Blenheim Way

Yaxley, Peterborough

We are pleased to present this impressive 3 bedroom semi-detached house, situated in a sought-after location. Boasting a total floor area of 81 square metres, this property offers ample space for a growing family. With an energy rating of C, this home is not only comfortable but also energy-efficient.

Upon entering, you are greeted by a spacious kitchen/breakfast room, providing the ideal space for culinary enthusiasts to whip up their favourite dishes. The kitchen is well-appointed, featuring modern appliances, ample storage. Adjacent to the kitchen is a lounge/dining room, perfect for entertaining friends and family or simply relaxing after a long day, French doors lead onto the patio.

Moving upstairs, you will find two double bedrooms and a single bedroom with storage cupboard, all of which receive an abundance of natural light.

This property also benefits from an enclosed rear garden, providing a private sanctuary for outdoor enjoyment and relaxation.

In addition, off-road parking is available for 2 to 3 vehicles, ensuring convenience and peace of mind for residents. Furthermore, the property enjoys easy access to the A1(M) and A605, making commuting a breeze for those who travel regularly.







HUDSON
HOMES

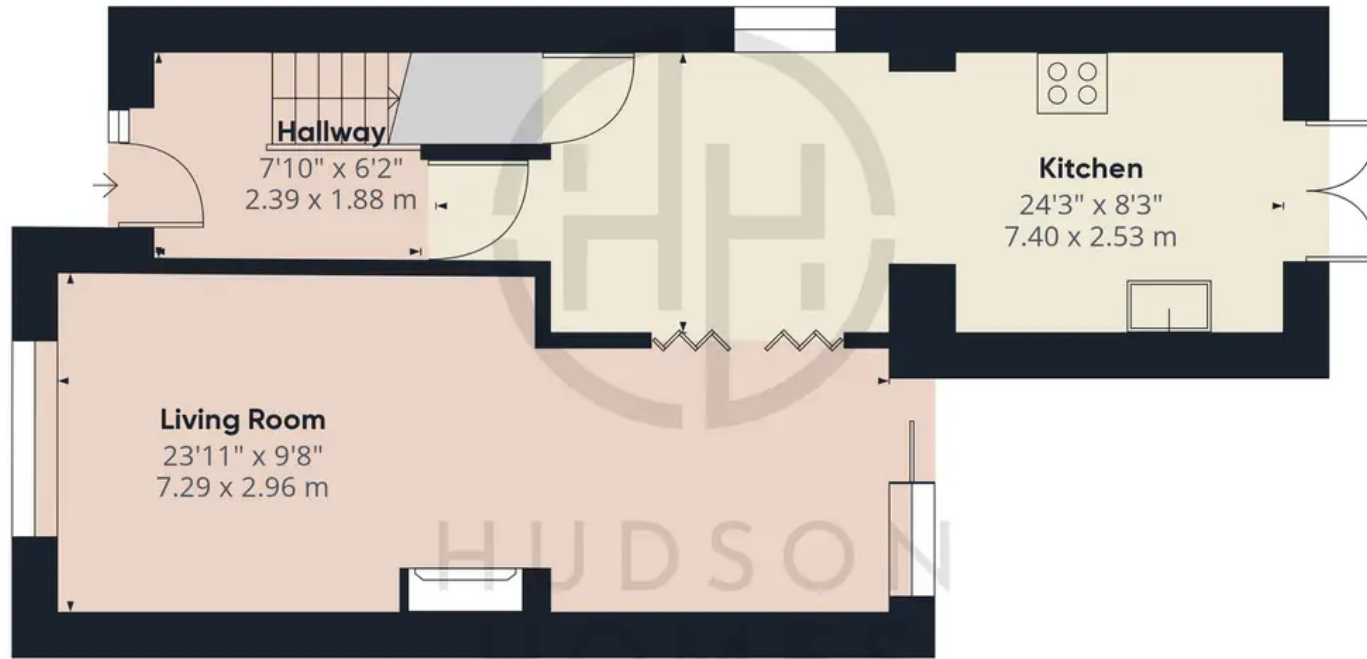

Floor 0

Approximate total area⁰¹

807.6 ft²

75.03 m²

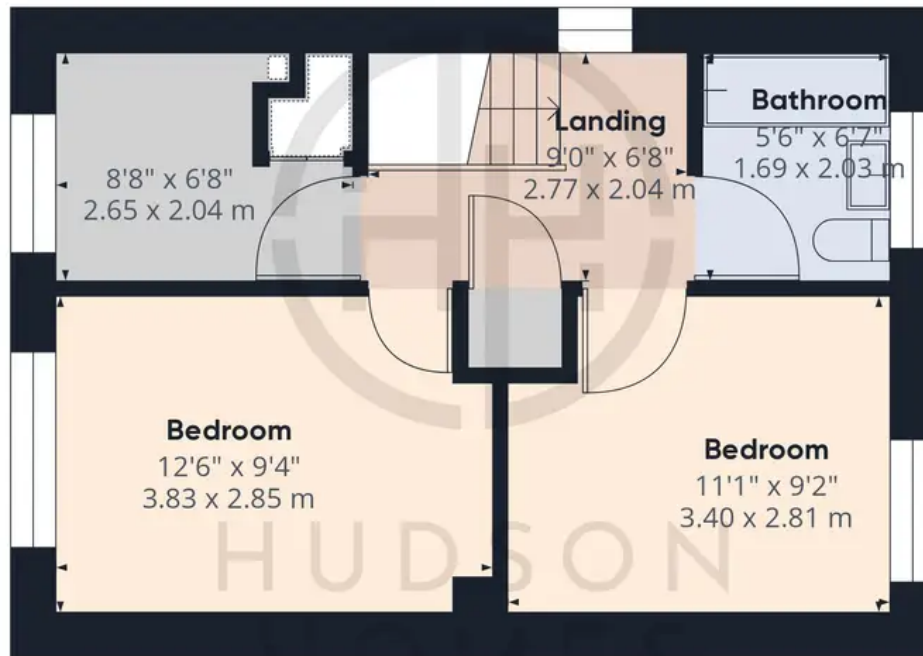

Floor 1

Excluding balconies and terraces

While every attempt has been made to ensure accuracy, all measurements are approximate, not to scale. This floor plan is for illustrative purposes only.

GIRAFFE360



Hudson Homes Estate Agents

122a Main Street, Yaxley - PE7 3LP

01733 788222

info@hudson-homes.co.uk

www.hudson-homes.co.uk/

